



Applications

Thrust bearing swivels are used to prevent wire rope or chain from transferring their normal twisting motion to the item being lifted. Our swivels can be supplied with various types of end-fittings.

Green Pin® swivels are not designed to rotate under load, but are intended as positioning devices only. For rotation under load, thrustbearing swivels should be used.

Range

Van Beest offers two types of swivels:

- Green Pin® swivels, ranging from Working Load Limit 0.39 up to 20.5 tons, with eye-eye or jaw-eye terminals.
- A full range of thrust-bearing swivels, Working Load Limit 3 tons up to 15 tons, with all possible types of combinations of terminals, where by the upper terminal is either an eye or a jaw (for semi-permanent fixation). Each thrust bearing swivel is individually proof tested. Large sizes of thrust bearing swivels up to 750 tons can be manufactured on request.

Design

The Green Pin® swivels are dropforged whereas the thrustbearing swivels are machined from carbon steel. The range of thrustbearing swivels we supply are fitted with grease nipples to ensure long life and ease of operation. Greasing depends on the frequency and intensity of use.

Each swivel carries the WLL marking, the manufacturer's symbol and the CE conformity code.

Finish

Green Pin® eye-eye and jaw-eye swivels are hot dipped galvanized.

The thrust bearing swivels are painted blue.

Certification

Test certificates can be supplied upon request.

Instructions for use

Swivels should be inspected before use to ensure that:

- all markings are legible;
- swivels are free from nicks, gouges and cracks;
- a swivel with the correct Working Load Limit has been selected with respect to the load to be carried;
- swivels may not be heat treated as this may affect their Working Load Limit;
- the bolt, nut or any other locking system cannot vibrate out of position.

The WLL should be applied in a straight pull and overloads are prohibited. Side loading is not allowed since the swivels are not designed for this purpose.

Never replace a swivel pin or nut with a bolt other than the one designed for the purpose, as it may not be suitable for the load imposed.

It is required that the products are regularly inspected and that the inspection should take place in accordance with the safety standards given in the country of use. This is required because the products in use may be affected by wear, misuse, overloading etc. with a consequence of deformation and alteration of the material structure.

Inspection should take place at least every six months and even more frequently when the swivels are used in severe operating conditions.

Green Pin® swivels

Eye - Eye

- **Material** : high tensile steel, quenched and tempered
- **Safety factor** : MBL equals 5 x WLL
- **Standard** : generally to US Federal Spec. RR-C-271, Type VII, Class 2
- **Finish** : hot dipped galvanized
- **Certification** : test certificates can be supplied upon request

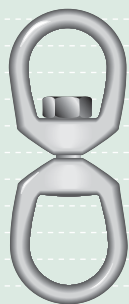

G-7713

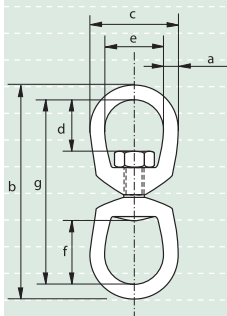

working load limit	diameter	length outside	width outside	length inside	width inside	length inside	length	weight per pce
tons	a mm	b mm	c mm	d mm	e mm	f mm	g mm	kg
0.39	6	87	32	17	19	27	75	0.1
0.57	8	106	41	21	25	32	90	0.18
1.02	10	130	51	24	32	38	110	0.32
1.6	13	164	64	33	38	51	138	0.6
2.4	16	199	76	40	44	60	167	1.13
3.3	19	221	89	44	51	67	183	1.82
4.5	22	257	102	52	57	78	213	2.83
5.7	25	295	114	59	64	89	245	4.06
8.2	32	355	143	68	80	94	291	7.43
20.5	38	511	178	106	102	106	435	20.8

Green Pin® swivels

Jaw - Eye

- **Material** : high tensile steel, quenched and tempered
- **Safety factor** : MBL equals 5 x WLL
- **Standard** : generally to US Federal Spec. RR-C-271, Type VII, Class 3
- **Finish** : hot dipped galvanized
- **Certification** : test certificates can be supplied upon request

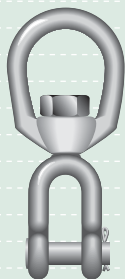

G-7723

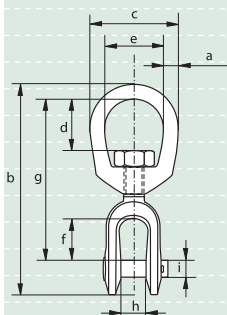

working load limit	diameter	length	width outside	length inside	width inside	length inside	length	width inside	diameter pin	weight per pce
tons	a mm	b mm	c mm	d mm	e mm	f mm	g mm	h mm	i mm	kg
0.39	6	86	32	17	19	22	67	12	6	0.11
0.57	8	98	41	21	25	22	75	13	8	0.17
1.02	10	121	51	24	32	27	92	16	10	0.32
1.6	13	154	64	33	38	33	114	19	13	0.65
2.4	16	186	76	40	44	38	135	24	16	1.12
3.3	19	211	89	44	51	44	154	28	19	1.76
4.5	22	242	102	52	57	52	178	30	22	2.66
5.7	25	297	114	59	64	71	217	44	28	4.46
8.2	32	341	143	68	80	71	248	52	35	7.14
20.5	38	529	178	106	102	112	375	73	57	24.8



P-7710

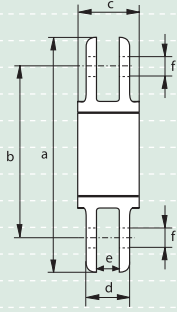

Thrust bearing swivels

Jaw - Jaw

- **Material** : carbon steel
- **Safety factor** : MBL equals 5 x WLL
- **Finish** : painted blue
- **Certification** : test certificates can be supplied upon request

working load limit	length a	length b	diameter c	width jaw outside d	width jaw inside e	diameter hole f	weight per pce
tons	mm	mm	mm	mm	mm	mm	kg
3	210	160	75	41	20	20	4.5
5	251	193	95	57	25	23	8.2
8.5	330	260	121	70	35	29	16.3
10	378	282	121	75	44	38	18.6
15	448	346	140	89	44	38	29



P-7720

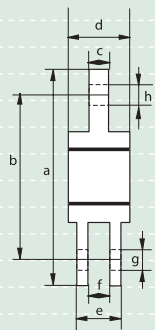

Thrust bearing swivels

Jaw - Eye

- **Material** : carbon steel
- **Safety factor** : MBL equals 5 x WLL
- **Finish** : painted blue
- **Certification** : test certificates can be supplied upon request

working load limit	length a	length b	thickness c	diameter d	width jaw outside e	width jaw inside f	diameter hole g	diameter hole h	weight per pce
tons	mm	mm	mm	mm	mm	mm	mm	mm	kg
3	203	153	20	75	41	20	20	23	4.1
5	244	183	25	95	57	25	23	32	7.7
8.5	321	248	32	121	70	35	29	35	15.9
10	368	272	44	121	75	44	38	41	18.6
15	438	333	51	140	89	44	38	51	29.5

Thrust bearing swivels

Eye - Jaw

- **Material** : carbon steel
- **Safety factor** : MBL equals 5 x WLL
- **Finish** : painted blue
- **Certification** : test certificates can be supplied upon request



P-7730

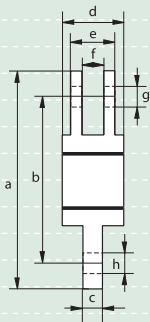

working load limit	length a	length b	thickness c	diameter d	width jaw outside e	width jaw inside f	diameter hole g	diameter hole h	weight per pce
tons	mm	mm	mm	mm	mm	mm	mm	mm	kg
3	203	153	20	75	41	20	20	23	4.1
5	244	183	25	95	57	25	23	32	7.7
8.5	318	248	32	121	70	35	29	35	15.9
10	362	272	44	121	75	44	38	41	18.6
15	429	333	51	140	89	44	38	51	29.5

Thrust bearing swivels

Eye - Eye

- **Material** : carbon steel
- **Safety factor** : MBL equals 5 x WLL
- **Finish** : painted blue
- **Certification** : test certificates can be supplied upon request



P-7740

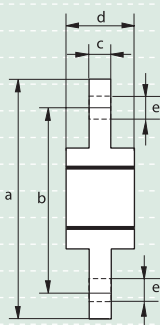

working load limit	length a	length b	thickness c	diameter d	diameter hole e	weight per pce
tons	mm	mm	mm	mm	mm	kg
3	200	150	20	75	23	3.6
5	238	174	25	95	32	6.8
8.5	308	232	32	121	35	15
10	352	256	44	121	41	17.7
15	419	311	51	140	51	28.1

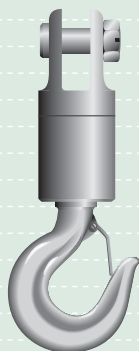

P-7750

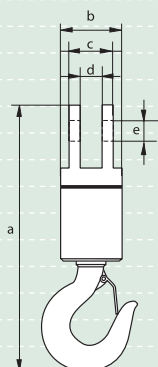

Thrust bearing swivels

Hook - Jaw

- **Material** : carbon steel
- **Safety factor** : MBL equals 5 x WLL
- **Finish** : painted blue
- **Certification** : test certificates can be supplied upon request

working load limit	length	diameter	width jaw outside	width jaw inside	diameter hole	weight per pce
tons	a mm	b mm	c mm	d mm	e mm	kg
3	273	75	41	20	20	5
5	337	95	57	25	23	9.5
8.5	457	121	70	35	29	20.8
10	479	121	75	44	38	24
15	578	140	89	44	38	36.3

Thrust bearing swivels

Hook - Eye

- **Material** : carbon steel
- **Safety factor** : MBL equals 5 x WLL
- **Finish** : painted blue
- **Certification** : test certificates can be supplied upon request

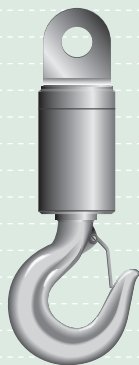

P-7760

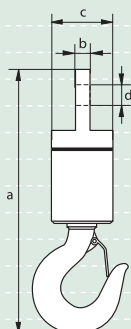

working load limit	length	thickness	diameter	diameter hole	weight per pce
tons	a mm	b mm	c mm	d mm	kg
3	270	20	75	23	4.5
5	330	25	95	32	9.1
8.5	448	32	121	35	20.4
10	470	44	121	41	23.6
15	568	51	140	51	35.4